



## HOUSE & LAND

GRANGE, WERRIBEE - TITLES AUG 2020

# \$649,987

**House name:** SAVANA 28

**Lot Number:** 1 - 110

**Lot Size:** 380m<sup>2</sup>

4 2 2

House and Land Package includes:

- 25 Year Structural Guarantee
- Carpets and tiles throughout
- 2590mm high ceilings
- Brickwork above all windows and doors to ground floor
- Automated LED Downlights to main living areas as per plan
- 20mm stone benchtops to the kitchen, bathroom and ensuite
- 900mm European SMEG appliances
- 600mm European SMEG dishwasher
- Panel Lift COLORBOND Garage door with 3 remotes
- Tiled shower bases to all showers
- Externally vented rangehood
- 3 coat paint system

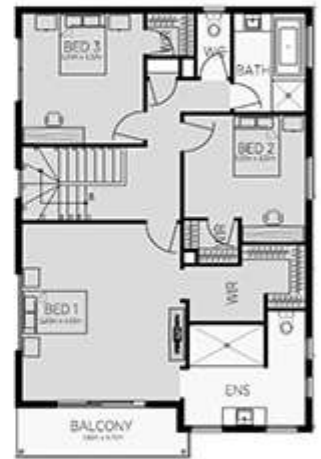

**CALL 0488227566 OR EMAIL [Shivakumar@nostrahomes.com.au](mailto:Shivakumar@nostrahomes.com.au)**

**YOU'LL BE SURPRISED BY WHAT WE CALL STANDARD**

The information contained in this flyer is to be used as a guide only. The flyer was completed prior to the engineering and construction of the particular home therefore design, engineering, dimensions, fittings and specifications are subject to change and will be specified in the final purchase and/or construction contract. The flyer includes features not supplied by Nostra Homes including without limitation landscaping, concrete driveways, fencing, water features and furniture. This flyer does not constitute part of an offer or contract. Prospective purchasers should rely on their own enquiries, legal advice and the contract of sale. Please contact our office if you have any questions regarding the property.