



HOUSE & LAND

EDGELEIGH, MT.COTTRELL

From \$489,900

House name: EDINBOROUGH 19

Lot Number: Lot 20

Lot Size: 294

4 2 2

House and Land Package includes:

- 25 Year Structural Guarantee
- Choice of tiles or timber laminate to main areas
- Carpet throughout remainder of home
- 2590mm high ceilings
- Brickwork to all windows and doors
- Smart LED Downlights to main areas
- 20mm stone bench to kitchen with waterfallends
- 20mm stone to bathroom and ensuite
- 900mm European SMEG appliances
- 600mm European SMEG dishwasher
- Panel Lift Colorbond Garage door+3 remotes
- Tiled shower bases to all showers
- Externally vented rangehood

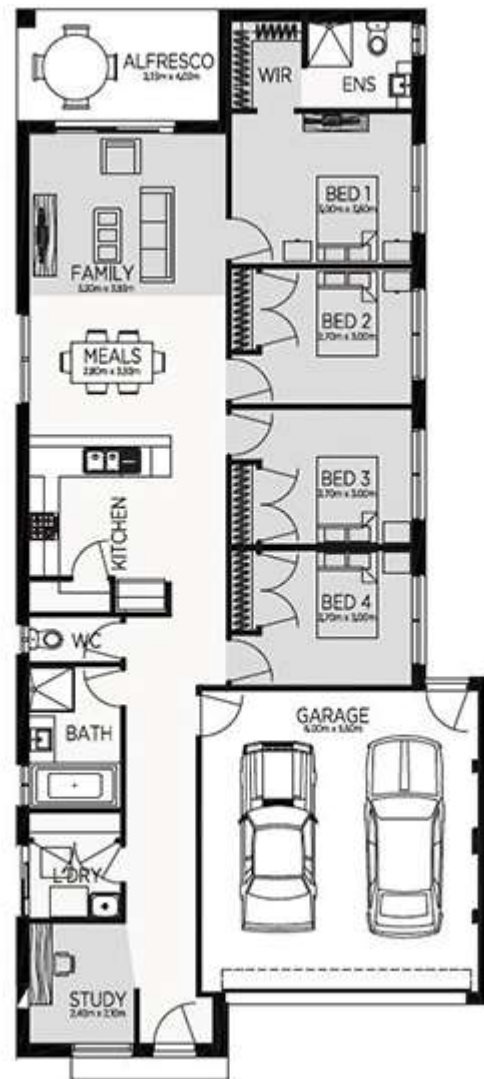

CALL 0488227566 OR EMAIL Shivakumar@nostrahomes.com.au

YOU'LL BE SURPRISED BY WHAT WE CALL STANDARD

The information contained in this flyer is to be used as a guide only. The flyer was completed prior to the engineering and construction of the particular home therefore design, engineering, dimensions, fittings and specifications are subject to change and will be specified in the final purchase and/or construction contract. The flyer includes features not supplied by Nostra Homes including without limitation landscaping, concrete driveways, fencing, water features and furniture. This flyer does not constitute part of an offer or contract. Prospective purchasers should rely on their own enquiries, legal advice and the contract of sale. Please contact our office if you have any questions regarding the property.